

AIMCO

FASTENER TOOLS

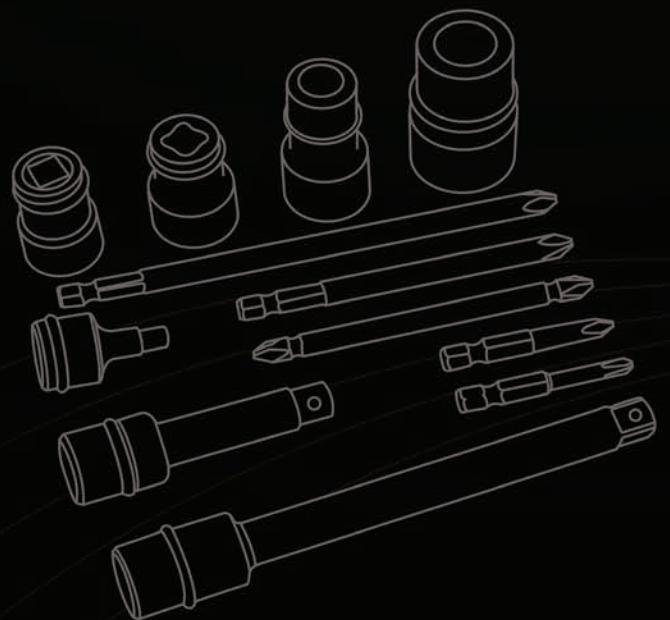



For over 40 years AIMCO has been working with manufacturers around the world, we are the complete global source for all assembly, fastening, and critical bolting needs. AIMCO can effectively and swiftly meet your needs whether you're in Thailand fastening a 3 mm nut at 3 Nm, or in Tennessee, USA torquing the last lug nut. AIMCO provides the tools and solutions, on a global scale, that guarantee the success of your project. It is with great pride that AIMCO can say the products that we manufacture are **MADE IN THE USA.**

TABLE OF CONTENTS

FASTENER TOOLS

STANDARD FASTENER TOOLS	4-5
ERGO-DRIVE® SERIES E *	6-7
CUSTOM / SPECIAL PARTS	8-11
CONVERSION CHARTS	12



* **E** logo indicates where ERGO-DRIVE sockets/extensions benefit tool operation.

ERGO-DRIVE sockets are uniquely designed to seat deeper on the tool anvil while an O-ring inside the socket fits tight onto the anvil to reduce vibration. By reducing run-out and vibration, ERGO-DRIVE sockets allow the most repeatable, accurate rundowns, ensuring excellent product quality, longer tool life, and better ergonomics for the tool user.

Look for the ERGO-DRIVE **E** logo in this catalog to see where ERGO-DRIVE sockets/extensions benefit tool operation, operator, and rundown. See page 6 for ERGO-DRIVE details.

STANDARD FASTENER TOOLS

EXTENSIONS

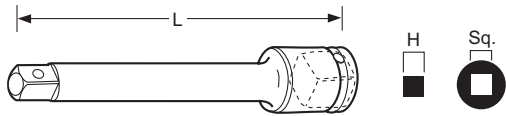

PART NO	SQ DRIVE	HEX	L MM	L IN	D MM	D IN
A375E	3/8"	3/8"	75	2.95	20	0.79
A405E	1/2"	1/2"	51	2.01	30	1.18
A610E	3/4"	3/4"	100	3.94	44	1.73
A810E	1"	1"	102	4.02	54	2.13
A1220E	1-1/4"	1-1/4"	200	7.87	60	2.36
A1418E	1-1/2"	1-1/2"	178	7.01	84	3.31
A2426E	2-1/2"	2-1/2"	264	10.39	137	5.39

BIT HOLDERS



PART NO	L MM	L IN
1/4" Hex, Magnetic		
A3BHM-3	75	2.94
A3BHM-4	100	3.94
A3BHM-6	150	5.91
A3BHM-8	200	7.87
A3BHM-10	250	9.84

SOCKET ADAPTERS



PART NO	FEMALE SQ. DRIVE	MALE SQ. DRIVE	D MM	D IN	L MM	L IN
A302A	3/8"	1/4"	22	0.87	35	1.38
A403A	1/2"	3/8"	25	0.98	37	1.46
A504A	5/8"	1/2"	35	1.38	47	1.46
A604A	3/4"	1/2"	38	1.50	53	2.09
A806A	1"	3/4"	50	1.97	70	2.76
A128A	1-1/4"	1"	60	2.36	76	2.99
A#508A	Spline #5	1"	60	2.36	90	3.54

UNIVERSAL SOCKETS



PART NO	HEX	D1 MM	D1 IN	D2 MM	D2 IN	L MM	L IN
3/8" Square Drive							
A310U	10 mm	16	0.63	20	0.79	55	2.17
A311U	11 mm	16	0.63	20	0.79	60	2.36
1/2" Square Drive							
A412U	12 mm	20.5	0.81	25	0.98	70	2.76
A413U	13 mm	19	0.75	24	0.95	70	2.76

Description of Bits and Nutsetters Part Number Nomenclature

Precedes Part Number

BITS

A3S	= Phillips® Power Drive
A3W	= Double Ended Phillips®
A38S	= Phillips® Insert
A39S	= Phillips® Insert Reduced Nose
A3M	= Slotted Power Drive
A38M	= Slotted Insert
A3MT	= Slotted Power Drive Reduced Nose
A3C	= Allen Socket Head Power Drive
A38C	= Allen Socket Head Insert
A3R	= Square Recess Power Drive
A3RT	= Square Recess Turned Down (Power)
A38R	= Square Recess Insert
A3T	= Torx® Power Drive
A38T	= Torx® Insert
A3TS	= Torq-Set® Power Drive
A38TS	= Torq-Set® Insert
A3TA	= Triangle Power Drive
A3TW	= Tri-Wing® Power Drive
A38TW	= Tri-Wing® Insert
A7	= 7/16 Power Drive
AS	= Electric Type Phillips®

BITS (Cont.)

AM	= Electric Type Slotted
ATW	= Electric Type Tri-Wing®
AT	= Electric Hios Type Torx®
A26S	= Electric Driver Phillips®
A26M	= Electric Driver Slotted
A26C	= Electric Driver Allen Socket Head
A3BHM	= Insert Bit Holder (Magnetic Type)
A3BHD	= Insert Bit Holder (Non Magnetic)

NUTSETTERS

A3B	= Nutsetter
A3BMP	= Magnetic (MP) Pressed Type
A3BMS	= Magnetic (MS) Spring Loaded
A3BMT	= Magnetic (MT) Tube Type
A3BU	= Universal Nutsetter

MAG-O-NETS

AM	= AIMCO Mag-O-Net®
----	--------------------

Contained Within Part Number

BITS

PZ	= Pozidriv®
PZACR	= Pozidriv® ACR®
SDV	= Supadriv®
TR	= Torx® Tamper Resistant
ACRI	= ACR® Installation
ACR	= ACR® Remove
ACRB	= ACR® 4x4 Both Install and Remove
E4	= Electric 4mm diameter
E5	= Electric 5mm diameter
RS	= Reduced Shank

Additional types and sizes of fastener tools are available upon request. Contact AIMCO at 1-800-852-1368.

STANDARD FASTENER TOOLS

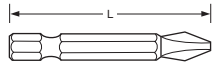

PART NO	POINT SIZE	L MM	L IN
A3S0-2	0	50	1.97
A3S1-2	1	50	1.97
A3S1-2.75	1	70	2.76
A3S1-3	1	75	2.95
A3S1-3.5	1	90	3.54
A3S1-4	1	100	3.94
A3S1-6	1	150	5.91
A3S2-1.2	2	30	1.18
A3S2-1.6	2	40	1.57
A3S3-2	3	50	1.97
A3S3-2.75	3	70	2.76

Double-Ended

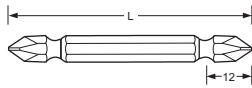

A3W1-3	1	75	2.94
A3W1-4	1	100	3.94
A3W2-2	2	50	1.97
A3W2-3	2	75	2.94
A3W2-4	2	100	3.94
A3W2-6	2	150	5.91
A3W2-8	2	200	7.87
A3W2-10	2	250	9.84
A3W2-12	2	300	11.81
A3W3-2	3	50	1.97
A3W3-3	3	75	2.94
A3W3-4	3	100	3.94
A3W3-6	3	150	5.91
A3W3-8	3	200	7.87

TORX POWER BITS



PART NO	TORX SIZE	L MM	L IN
A3T6-2	T6	50	1.97
A3T7-2	T7	50	1.97
A3T7-2.75	T7	70	2.76
A3T7-3.5	T7	90	3.54
A3T7-6	T7	150	5.91
A3T8-2	T8	50	1.97
A3T9-2.75	T9	70	2.76

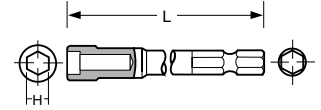

PART NO	HEX	L MM	L IN
A3B1/4-2	1/4"	50	1.97
A3B1/4-2.5	1/4"	63	2.50
A3B5/16-2	5/16"	50	1.97
A3B5/16-2.5	5/16"	63	2.50
A3B3/8-2	3/8"	50	1.97
A3B3/8-2.5	3/8"	63	2.50
A3B05-2.75	5 mm	70	2.76
A3B55-1.2	5.5 mm	30	1.18
A3B55-2.75	5.5 mm	70	2.76
A3B55-4	5.5 mm	100	3.94
A3B06-2.75	6 mm	70	2.76
A3B07-1.2	7 mm	30	1.18
A3B07-2	7 mm	50	1.97
A3B07-2.75	7 mm	70	2.76
A3B07-4	7 mm	100	3.94
A3B08-1.2	8 mm	30	1.18
A3B08-2	8 mm	50	1.97
A3B08-2.75	8 mm	70	2.76
A3B08-4	8 mm	100	3.94
A3B08-6	8 mm	150	5.91
A3B08-8	8 mm	200	7.87
A3B09-2.75	9 mm	70	2.76
A3B09-4	9 mm	100	3.94
A3B10-1.2	10 mm	30	1.18
A3B10-2	10 mm	50	1.97
A3B10-2.75	10 mm	70	2.76
A3B11-2.75	11 mm	70	2.76
A3B12-1.2	12 mm	30	1.18
A3B13-2.75	13 mm	70	2.76
A3B14-2.75	14 mm	70	2.76
A3B16-2.75	16 mm	70	2.76
A3B17-2.75	17 mm	70	2.76

MAG-O-NETS®*

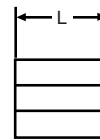
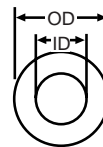

*U.S. Patent 5861789

PART NO	TORX SIZE	L MM	L IN
AM1/4Z	7 mm	19 mm	10 mm
AM5Z	6 mm	17.5 mm	10 mm
AM3/16Z	3/16	17.5 mm	10 mm

For custom parts, please contact us for more information, 1-800-852-1368.

Additional types and sizes of fastener tools are available upon request. Contact AIMCO at 1-800-852-1368.

ERGO-DRIVE® SERIES

ERGO-DRIVE® SOCKETS PROTECT...

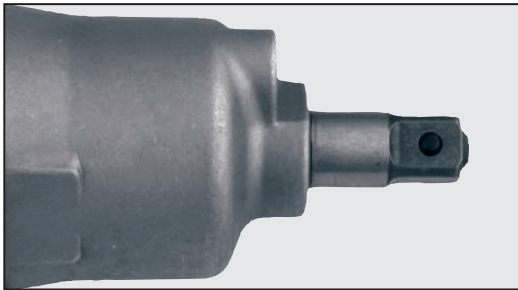

...YOUR INVESTMENT!

Pulse tools are an investment and the anvil is the most expensive single part of any pulse tool. ERGO-DRIVE® sockets decrease vibration and wear on this critical component.

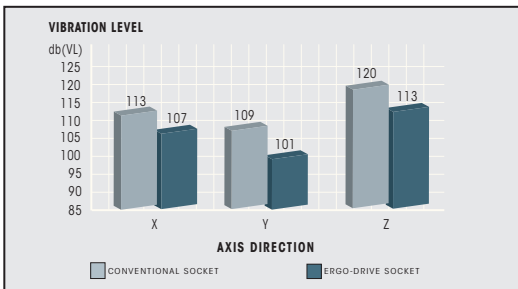
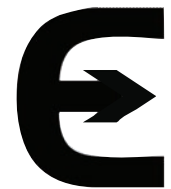

...YOUR ASSEMBLERS!

ERGO-DRIVE® sockets cause significantly less vibration during fastening than conventional sockets. This allows your assemblers to do their jobs without the worry of vibration related injuries.

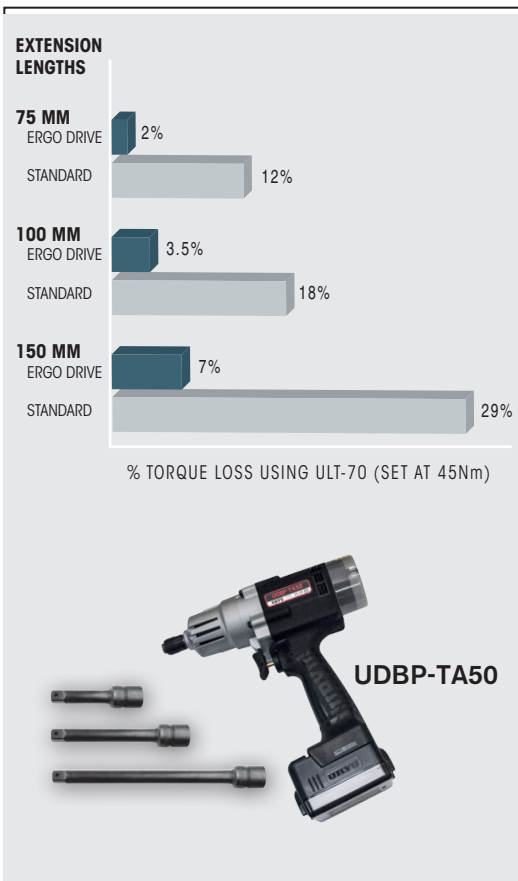

...YOUR PRODUCTS!

By reducing run-out and vibration, ERGO-DRIVE® sockets allow the most repeatable, accurate rundowns to take place, ensuring excellent product quality.

ERGO-DRIVE® VS. STANDARD

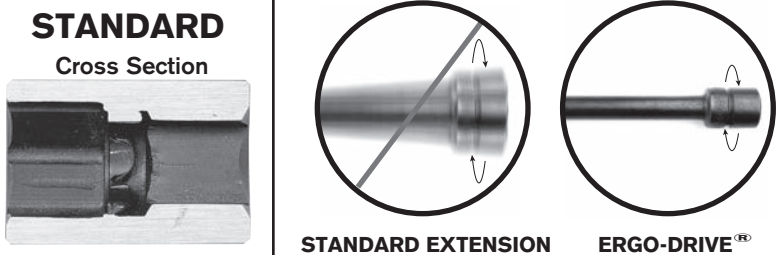

ERGO-DRIVE® FASTENER TOOLS

ERGO-DRIVE® SOCKETS

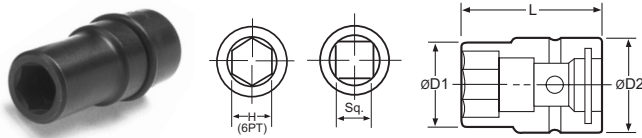

PART NO	HEX	D1 MM	D1 IN	D2 MM	D2 IN	L MM	L IN
---------	-----	----------	----------	----------	----------	---------	---------

3/8" Square Drive							
A314EDS	1/4"	10	0.39	19	0.75	44	1.73
A312EDS	1/2"	20	0.77	22	0.87	44	1.73
A306EDS	6 mm	10	0.39	19	0.75	44	1.73
A308EDS	8 mm	14	0.55	20	0.79	42	1.65
A310EDS	10 mm	17	0.65	20	0.79	42	1.65
A312EDS	12 mm	20	0.79	20	0.79	42	1.65
A314EDS	14 mm	22	0.87	20	0.79	42	1.65
A316EDS	16 mm	25	0.98	20	0.79	45	1.77
A318EDS	18 mm	27	1.06	20	0.79	45	1.77

1/2" Square Drive							
A412EDS	1/2"	19	0.75	25	0.98	50	1.97
A413EDS	13 mm	22	0.85	25	0.98	52	2.05
A414EDS	14 mm	23	0.89	25	0.98	52	2.05
A415EDS	15 mm	24	0.93	25	0.98	52	2.05
A416EDS	16 mm	25	0.98	25	0.98	52	2.05
A417EDS	17 mm	28	1.10	28	1.10	54	2.13
A418EDS	18 mm	29	1.14	28	1.10	54	2.13
A419EDS	19 mm	30	1.18	28	1.10	54	2.13

3/4" Square Drive							
A61-1/8EDS	1-1/8"	44	1.73	44	1.73	64	2.52
A61-1/4EDS	1-1/4"	49	1.91	44	1.73	66	2.60
A61-1/2EDS	1-1/2"	57	2.24	44	1.73	68	2.68
A618EDS	18 mm	31	1.22	44	1.73	60	2.36
A624EDS	24 mm	40	1.52	40	1.73	65	2.36

1" Square Drive							
A815/16EDS	15/16"	38	1.50	54	2.13	69	2.72
A8100EDS	100 mm	136	5.35	76	2.99	120	4.72

SEE ALSO: STUD BOLT SOCKETS

PART NO	THREAD SIZE	LENGTH MM	LENGTH IN	DRIVE IN
A314P20	1/4-20"	55	2.17	3/8
A305P0.8	M5	42	1.65	3/8
A414P20	1/4-20"	65	2.59	1/2
A408P1.0	M6	50	1.97	1/2

ERGO-DRIVE® EXTENSIONS

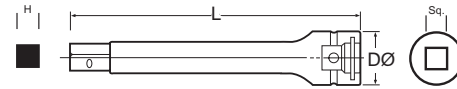

PART NO	SQ DRIVE	H	L MM	L IN	D MM	D IN
---------	-------------	---	---------	---------	---------	---------

3/8" Square Drive						
A352EDE	3/8"	3/8"	52	2.05	20	0.79
A3100EDE	3/8"	3/8"	100	3.94	20	0.79
A375EDE	3/8"	3/8"	75	2.95	20	0.79
A3150EDE	3/8"	3/8"	150	5.91	20	0.79
A3190EDE	3/8"	3/8"	190	7.48	20	0.79
A3254EDE	3/8"	3/8"	254	10.00	20	0.79
A3300EDE	3/8"	3/8"	300	11.81	20	0.79
A3320EDE	3/8"	3/8"	320	12.60	20	0.79

1/2" Square Drive						
A464EDE	1/2"	1/2"	64	2.52	28	1.10
A476EDE	1/2"	1/2"	76	2.99	28	1.10
A4125EDE	1/2"	1/2"	125	4.92	28	1.10
A4204EDE	1/2"	1/2"	204	8.03	28	1.10
A4254EDE	1/2"	1/2"	254	10.00	28	1.10
A4355EDE	1/2"	1/2"	355	13.98	28	1.10

3/4" Square Drive						
A676EDE	3/4"	3/4"	76	2.99	40	1.58
A6100EDE	3/4"	3/4"	100	3.94	40	1.58
A6150EDE	3/4"	3/4"	150	5.91	40	1.58
A6200EDE	3/4"	3/4"	200	7.87	40	1.58

1" Square Drive						
A8150EDE	1"	1"	150	5.91	54	2.13
A8200EDE	1"	1"	200	7.87	54	2.13

QUICK CHANGE CHUCKS



PART NO	SQUARE DRIVE	HEX
---------	--------------	-----

3/8" Square Drive		
ADC-3SEDSQ	3/8"	1/4"
ADC-3SEDSQH7/16	3/8"	7/16"

1/2" Square Drive		
ADC-4SEDSQ	1/2"	1/4"
ADC-4SEDSQH7/16	1/2"	7/16"

Additional types and sizes of fastener tools are available upon request. Contact AIMCO at 1-800-852-1368.

CUSTOM BITS, SOCKETS, AND EXTENSIONS

CUSTOM BITS, SOCKETS, AND EXTENSIONS FOR THE POWER TOOL USER

AIMCO can provide specials for virtually any application. From design to delivery, AIMCO's quick response ensures high quality, tight tolerance specials.

Specials are available in every style including:

- Deep Socket
- Extended Socket
- Universal
- Allen Head
- Torx Head
- Socket Adapter
- Nut Runner Socket
- Nut Runner Joint
- Nutsetter
- Magnetic Nutsetter
- Universal Nutsetter
- Screwdriver Bits



Sample request forms are shown. Your detailed requirements will allow AIMCO to quickly respond with custom solutions for your fastening requirements.

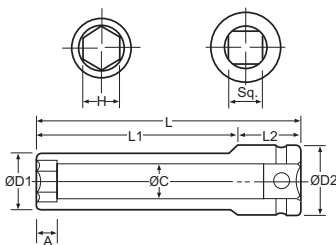

SOCKET

Magnet MP / MT / MS	H	L	L ₁	L ₂	A	ØC	ØD ₁	ØD ₂	Sq.
SIZE									
TYPE									

SPECIAL PARTS

SOCKET TYPES:



DOUBLE HEX
D (12 PT)
(DH)



SURFACE DRIVE
(SF)



DOUBLE SQUARE
(DSQ)



FLANK DRIVE
(FD)



SINGLE HEX
H (6 PT)
(SH)



FAST LEAD
(FL)



SINGLE SQUARE
(SQ)



HEX LOBULE
(TORX)

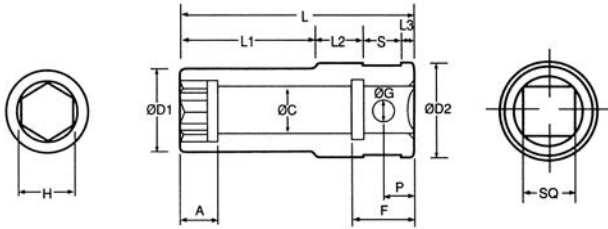

NUTRUNNER SOCKET TYPE A

Min. Qty. 10

Magnet MP MT MS	H	L	L ₁	L ₂	L ₃	S	ØD ₁	A	ØC	ØG	P	F	ØD ₂	Sq.	Qty.
SIZE															
TYPE															

✓ Box for Ergo-Drive

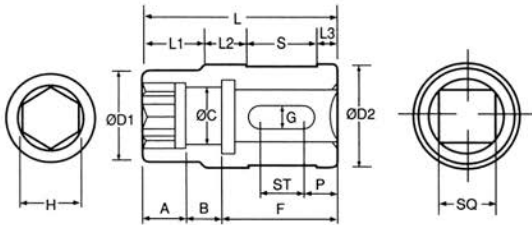

NUTRUNNER SOCKET TYPE B

Min. Qty. 10

H	L	L ₁	L ₂	L ₃	S	ØD ₁	A	B	ØC	G	P	F	ST	ØD ₂	Sq.	Qty.
SIZE																
TYPE																

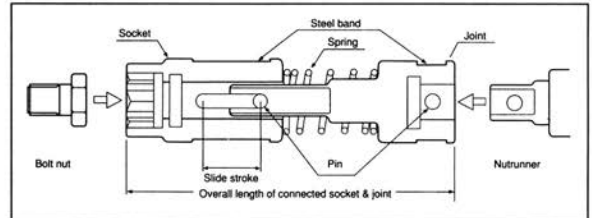
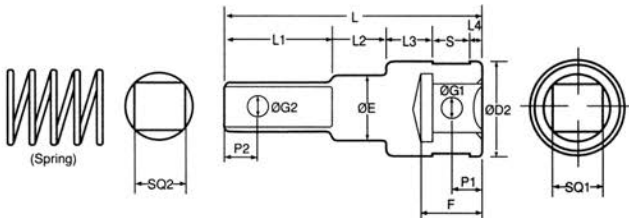

NUTRUNNER JOINT TYPE B

Min. Qty. 10

SQ ₂	L	L ₁	L ₂	L ₃	L ₄	S	P ₁	ØG ₂	ØE	F	ØG ₁	P ₂	ØD ₂	SQ ₁	Qty.

✓ Box for Ergo-Drive

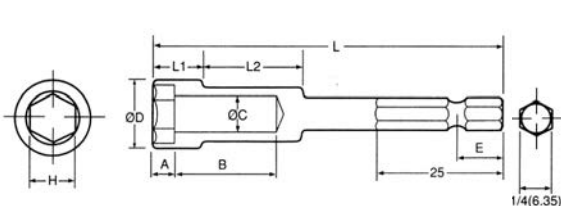

NUT SETTER

Min. Qty. 10

H	ØD	L	E	L ₁	L ₂	A	B	ØC	Qty.
SIZE									
TYPE									

SPECIAL PARTS

MAGNETIC STYLES:

MP (Press-inserted) Type

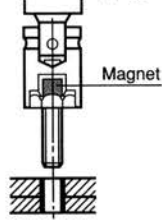

MS (Sliding) Type

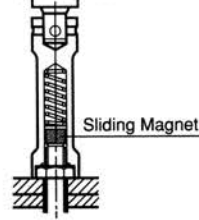

MT (Tube) Type

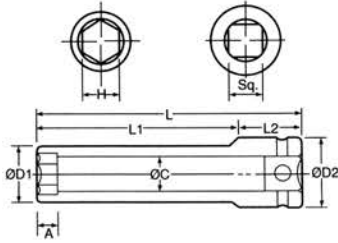
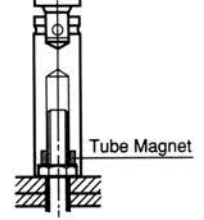

SOCKET

Min. Qty. 10

Magnet		H	L	L ₁	L ₂	A	ØC	ØD ₁	ØD ₂	Sq.	Qty.
MP	MT MS										
SIZE											
TYPE											

√ Box for Ergo-Drive

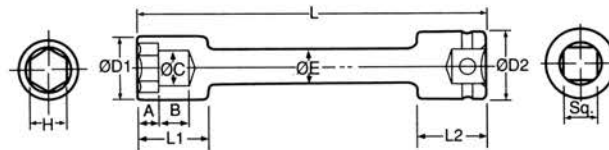

EXTENSION SOCKET

Min. Qty. 10

Magnet		H	L	L ₁	L ₂	A	B	ØC	ØD ₁	ØD ₂	ØE	Sq.	Qty.
MP	MT MS												
SIZE													
TYPE													

√ Box for Ergo-Drive

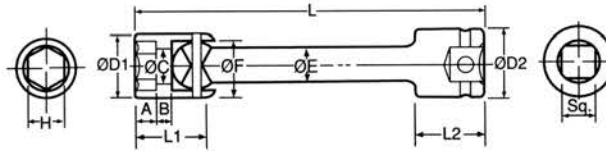

UNIVERSAL SOCKET

Min. Qty. 10

Magnet		H	L	L ₁	L ₂	A	B	ØC	ØD ₁	ØD ₂	ØE	ØF	Sq.	Qty.
MP	MT MS													
SIZE														
TYPE														

√ Box for Ergo-Drive

ALLEN HEAD/TORX HEAD

Min. Qty. 10

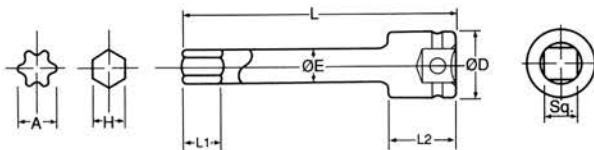

Torx	H	L	L ₁	L ₂	ØD	ØE	Sq.	Qty.

√ Box for Ergo-Drive

SOCKET ADAPTER

Min. Qty. 10

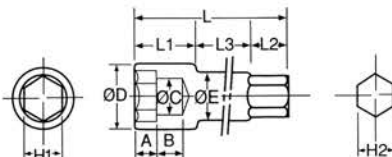

H ₁	L	L ₁	L ₂	L ₃	ØD	A	B	ØC	ØE	H ₂	Qty.

SPECIAL PARTS

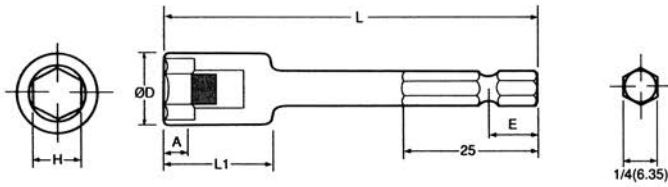

(MP) MAGNETIC NUT SETTER

Min. Qty. 10

	H	L	E	L ₁	ØD	A	Qty.
SIZE							
TYPE							

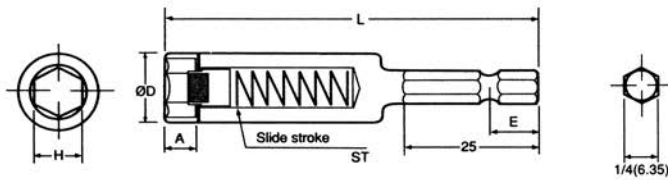

(MS) MAGNETIC NUT SETTER

Min. Qty. 10

	H	L	E	ØD	A	ST	Qty.
SIZE							
TYPE							

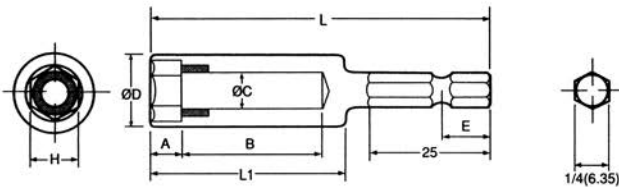

(MT) MAGNETIC NUT SETTER

Min. Qty. 10

	H	L	E	L ₁	ØD	A	B	ØC	Qty.
SIZE									
TYPE									

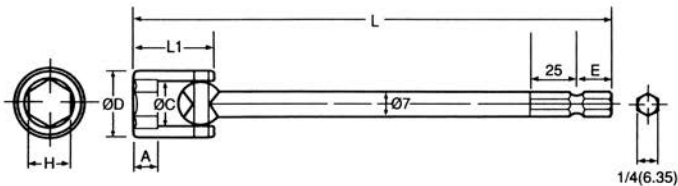

UNIVERSAL NUT SETTER

Min. Qty. 10

	H	L	E	L ₁	A	ØC	ØD	Qty.

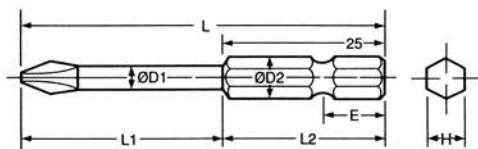

SCREWDRIVER BIT

Min. Qty. 500

	Point Size	L	L ₁	L ₂	ØD ₁	ØD ₂	E	H	Qty.

CIRCLE ONE:



CONVERSION CHARTS

Fraction ■ Decimal ■ Metric Conversions (to .32)

	Decimal	mm		Decimal	mm		Decimal	mm		Decimal	mm
1/32	.03125	.7938	9/32	.28125	7.1438	17/32	.53125	13.4938	25/32	.78125	19.8438
1/16	.0625	1.5875	5/16	.3125	7.9375	9/16	.5625	14.2875	13/16	.8125	20.6375
3/32	.09375	2.3812	11/32	.34375	8.7312	19/32	.59375	15.0812	27/32	.84375	21.4312
1/8	.125	3.175	3/8	.375	9.525	5/8	.625	15.875	7/8	.875	22.225
5/32	.15625	3.9688	13/32	.40625	10.3188	21/32	.65625	16.6688	29/32	.90625	23.0188
3/16	.1875	4.7625	7/16	.4375	11.1125	11/16	.6875	17.4625	15/16	.9375	23.8125
7/32	.21875	5.5562	15/32	.46875	11.9062	23/32	.71875	18.2562	31/32	.96875	24.6062
1/4	.25	6.35	1/2	.5	12.7	3/4	.75	19.05	1	1.0	25.4

Thread Size to Hex Size



	MM		MM	UNC	INCHES	SAE	INCHES
M 2	4	M 27	41	1/4	7/16	1/4	7/16
M 2.3	4.5	M 30	46	5/16	1/2	5/16	1/2
M 2.6	5	M 33	50	3/8	9/16	3/8	9/16
M 3	5.5	M 36	55	7/16	11/16	7/16	5/8
M 3.5	6	M 39	60	1/2	3/4	1/2	3/4
M 4	7	M 42	65	9/16	7/8	9/16	7/8
M 5	8	M 45	70	5/8	15/16	5/8	15/16
(M 5-6)	9	M 48	75	3/4	1-1/8	3/4	1-1/16
M 6	10	M 52	80	7/8	1-5/16	7/8	1-1/4
M 7	11	M 56	85	1	1-1/2	1-1/8	1-7/16
M 8	13	M 60	90	1-1/8	1-11/16	1-1/4	1-13/16
(M 8)	14	M 64	95	1-1/4	1-7/8	1-3/8	2
M 10	16	M 68	100	1-3/8	2-1/16	1-1/2	2-3/16
(M 10)	17	M 72	105	1-1/2	2-1/4		
M 12	18	M 76	110	1-3/4	2-5/8		
(M 12)	19	M 80	115	2	3		
M 14	21	M 85	120	2-1/4	3-3/8		
(M 14)	22	M 90	130	2-1/2	3-3/4		
M 16	24	M 95	135				
M 18	27	M 100	145				
M 20	30	M 105	150				
(M 22)	32	M 110	155				
M 22	34	M 115	165				
M 24	36	M 120	170				

Torque Conversion Factors

Units to be	SAE			METRIC			INTERNATIONAL SYSTEM - S.I.		
Converted	ozf-in	lbf-in	lbf-ft	gf-cm	kgf-cm	kgf-m	mNm	cNm	Nm
1 ozf-in	= 1	0.0625	0.005	72	0.072	0.0007	7.062	0.706	0.007
1 lbf-in	= 16	1	0.083	1152.1	1.152	0.0115	113	11.3	0.113
1 lbf-ft	= 192	12	1	13826	13.83	0.138	1356	135.6	1.356
1 gf-cm	= 0.014	0.0009	0.00007	1	0.001	0.00001	0.098	0.01	0.0001
1 kgf-cm	= 13.89	0.868	0.072	1000	1	0.01	98.07	9.807	0.098
1 kgf-m	= 1389	86.8	7.233	100000	100	1	9807	980.7	9.807
1 mN-m	= 0.142	0.009	0.0007	10.2	0.01	0.0001	1	0.1	0.001
1 cN-m	= 1.42	0.088	0.007	102	0.102	0.001	10	1	0.01
1 N-m	= 141.6	8.851	0.738	10197	10.20	0.102	1000	100	1



AIMCO CORPORATE HEADQUARTERS

10000 SE PINE STREET
PORTLAND, OREGON 97216

PHONE: (503) 254-6600
TOLL FREE: 1-800-852-1368

AIMCO CORPORATION DE MEXICO SA DE CV

AVE. CRISTOBAL COLON 14529
CHIHUAHUA, CHIHUAHUA. 31125
MEXICO

PHONE : (01-614) 380-1010
FAX : (01-614) 380-1019

AIMCO CHINA

ROOM 607, NO.3998 HONGXIN RD,
DIBAO PLAZA, MINHANG DISTRICT,
SHANGHAI, 201103
CHINA

PHONE: 0086-21-34319246
FAX: 0086-21-34319245

AIMCO EUROPE

AVENIDA RÍO GALLO, 431
19174 GALÁPAGOS - GUADALAJARA
SPAIN

PHONE: +34 673 34 99 25

WWW.AIMCO-GLOBAL.COM

LIT-AT125 REV _04-15, PRINTED IN USA, ©2015 AIMCO

FASTENER